



TECHNICAL SPECIFICATIONS WIREHOOD

Doc. Nr.:ING.CL01.ZZ.323/001

Revision: A

Pag.1/1

FINISHED PRODUCT

CUSTOMER:.....INDUSTRIA CORCERA
 ICAS Product code:...VARU38CL
 Customer Product code:

DIMENSIONAL CHARACTERISTICS

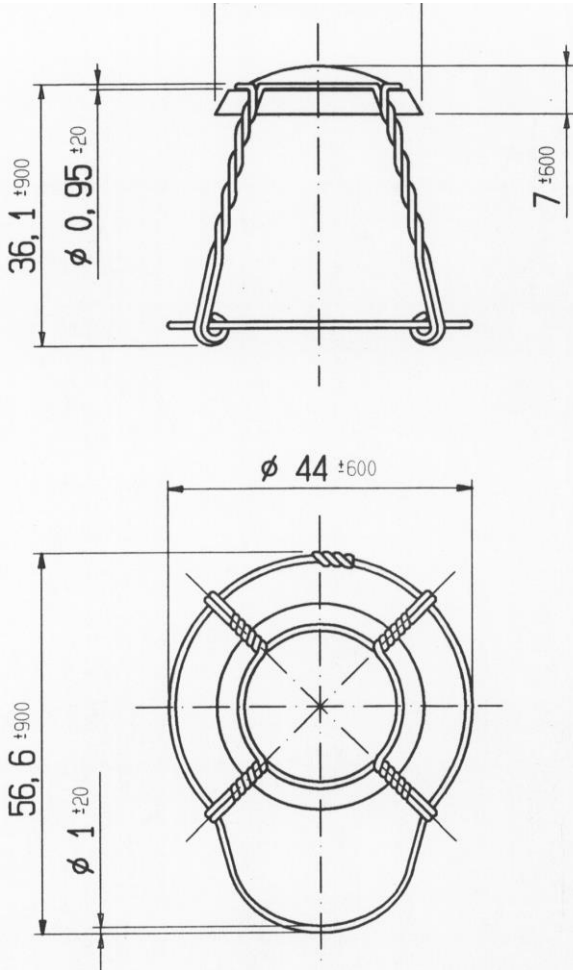

STANDARD WIREHOOD

RAW MATERIAL

Body wire:

- MATERIAL:Galvanized mild steel wire
- DIAMETER: 0.95 mm ± 0.02
- BREAKING POINT: 300-450 N/mm² (determined according to ISO 6892)
- ELONGATION: minimum 18% (length of sample: 150 mm)
- TWISTS ON DOUBLE WIRE: minimum 42 (length of sample: 180 mm)

Belt wire:

- MATERIAL:Galvanized mild steel wire
- DIAMETER: 1.00 mm ± 0.02
- BREAKING POINT: 320-450 N/mm² (determined according to ISO 6892)
- ELONGATION: minimum 23% (length of sample: 150 mm)
- TWISTS ON DOUBLE WIRE: minimum 55 (length of sample: 210 mm)

Disc:

- MATERIAL: Electrolytic tin-plated metal sheet;
- QUANTITY OF TIN: 2,8 gr/m² on each side;
- HARDNESS OF THE MATERIAL: T-57 scale; 53-61 Rockwells;
- THICKNESS: 0.23 mm ± 0.01
- PRINTING: Epoxyphenolic lithography (or varnishing) and final varnishing.

Diameter:35 mm

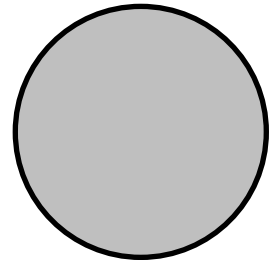

PACKAGING

Pallet	Container(Doc.N.SPI.44 dated 05/02/97)
36 Boxes	cardboard box of 2700 pcs with 100 wirehoods per stick